

PR7 Mini Full Encrypt (Onboard)

Quick Start Guide

Our New PR7 Mini Retail body-worn video (BWV) is the ideal fit for customer-facing staff. The miniature design is perfectly formed to fit uniforms or everyday casual wear. The lightweight unit houses an impressive power-packed feature list, including impressive memory storage.



PR7 Mini FEATURE LIST

1. COMPACT SIZE: 63.5MM x 50.5MM x 26.1MM
2. ONLY 75g WEIGHT
3. 360 DEGREES ROTATABLE CROCODILE MOUNT OR STUD FOR KICKFAST MOUNT
4. 500+ HOURS STANDBY TIME
5. 8 HOURS RECORD TIME
6. 3 HOURS CHARGING TIME
7. 30 SECOND PRE-RECORD TIME
8. ULTRA LOW LIGHT PERFORMANCE
9. 32GB BUILT-IN MEMORY
10. 1080P VIDEO RESOLUTION
11. IP RATING OF IP65
12. 6 AXIS IMAGE STABILISER
13. COMPATIBLE WITH DEMS AND CLOUD

Getting Started

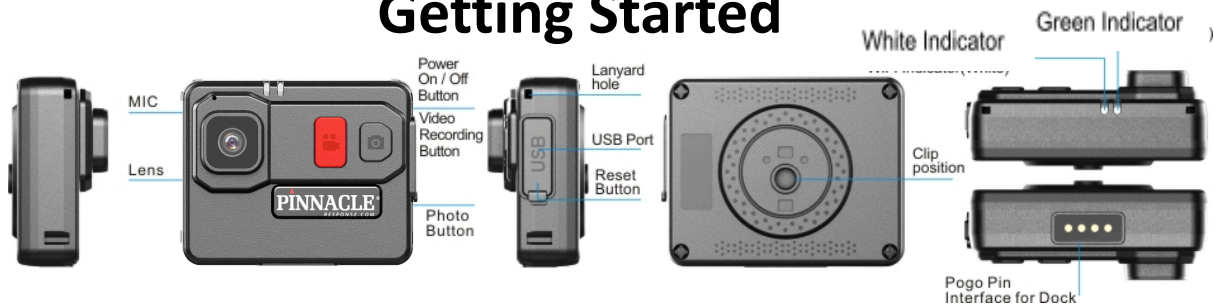

Power On/Off

Press and hold the Red Record button for 3 seconds. The unit will give an audible chirp and the white LED indicator will illuminate, indicating that the camera is on standby. Camera will enter into standby mode. In standby mode, the white LED indicator stays ON. To power off, press and hold the Record button for 3 seconds, the unit will give 2 audible chirps and white LED indicator will turn off.

Recording From Standby

Press the Red Record button to start recording. The unit will give one audible chirp and the green LED indicator will flash consistently, indicating that the camera is now recording. When the camera is recording, press the red record button to stop recording. The unit will give two audible chips and the green LED indicator will turn off, the white LED indicator will turn back on.

Photo Taking

Photograph Feature In standby mode, press the Photo button to take photos. The unit will give one audible chirp and the white LED indicator will blink once.

Pre-Record

When the camera is in standby mode, long press the photo button to switch to pre-record. The white LED indicator on top of the camera will change to solid green and the camera will pre-record for 30 seconds. To stop pre-recording, long press the photo button.

Insufficient Storage

When free storage space is less than 5%, the green LED will change to red whilst still recording.

DEMS and Cloud

The PR7 mini is compatible with our DEMS and cloud solution. Securely log in to DEMS to view your footage. With the cloud there is no need for expensive on site servers as everything is saved on the AWS servers in your area.



Docking Procedure

When docking the PR7 Mini, You must ensure that the left LED has turned solid Red and that you hear the USB Notification Sound from your PC or the PR7 mini beep. If the Left LED does not turn solid red, please undock the camera and redock until the RED LED appears.

LED Functions

Status	LED 1	LED 2	Meaning
Not docked		OFF	Camera is off
		Solid White	Camera is on, pre-record is off
	Solid Green		Camera is on, pre-record is on
	Flashing Green		Camera is recording
	Flasing Red		Camera is recording, battery is low
	Flashing Red	Flashing White	Camera storage is full
	Flashing Green		Camera is searching for WiFi (manual uploading)
	Solid Green		Camera is connected to WiFi (manual uploading)
	Flashing Green	Flashing White	Camera is uploading (manual uploading)
Docked, connected to PC		OFF	Camera is fully charged
		Solid Blue	Camera is charging
	Solid Red		Storage is locked
	Solid Green		Storage is unlocked
	Flashing Red		Camera is transferring data
Docked, connected to power	OFF		Storage is empty
		OFF	Camera is fully charged
		Solid Blue	Camera is charging
	Flashing Green		Camera is searching for WiFi
	Solid Green		Camera is connected to WiFi
	Flashing Green	Flashing White	Camera is uploading

Please note - The camera can be removed from the dock before the blue light has gone off.
However usage may be limited as the battery is not completely charged

Charging

The camera can be charged via USB, single dock or a multi dock. The camera can charge through a USB plugged into a wall plug or plugged into a computer via the USB or single dock.

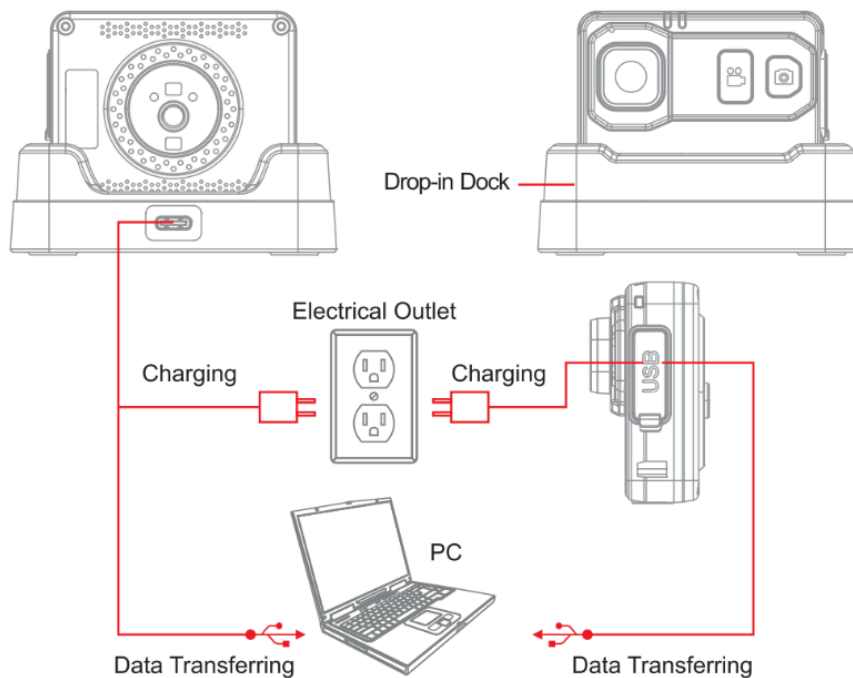

Troubleshooting

If you are having problems with your camera, please first fully charge it and power it on, then press the reset button with the reset tool. Reset button is below the USB-C port. Pressing the reset button will force the camera to shut off. Press the power button to turn the device back on and your device should now be working properly. Resetting the device will not delete any files. If you have further issues please contact our support team on support@pinnacleresponse.com



Standard Uploading Options

Direct upload via your
sites wifi



Direct upload via a 4G
router



If the above options do not work for you please let us know and we can tailor a solution for you

Viewing the footage

All footage is uploaded via the options above to DEMS which is hosted on the cloud. To access this log in to DEMS at <https://dems.pinnacleresponse.com> and enter in your username and password.